

BPC30 undercarriage battery connector

Brief introduction

- Crimping termination, vehicle mounting
receptacle is pin & socket type
- Enterprise standard: Q/21E1660

Application

The product is push-pull in-line connector without locking function which is achieved by the locking mechanism between equipments. This series is used in the current transmission between battery box and vehicle side, battery wire and charging side.

Operating environment

The product is applied in vibration environment in EV driving process.

Main technical characteristics

[Mechanical]

- Shell: aluminum substrate, nickel plating
- Insulator: PBT, flame retardant rating: UL94-V0
- Contact: copper alloy, gold plating
- Vibration: 10~500Hz
- Endurance: 10000 cycles

[Environmental]

- Operating temperature: -40°C ~ +80°C
- Salt spray: 96 hours

[Electrical]

- Rating current:
Signal 2A, auxiliary 20A, power 250A,
grounding 80A
- Contact resistance:
Signal and auxiliary $\leq 0.75 \text{ m}\Omega$,
power and grounding $\leq 0.5 \text{ m}\Omega$
- Insulation resistance:
 $\geq 100 \text{ M}\Omega$ (normal temperature, after wiring)
- Withstanding voltage:
between power and grounding 3000V AC
Between signal cavities: 500VAC

Ordering information

Basic series	BPC	30	-S-	250A	/	750V
Connector type						
Contact type	S=socket	P=pin				
Rating current						
Separator						
Rating voltage						

Outline dimensions

[BPC30-P-250A/750V (Battery box plug)]

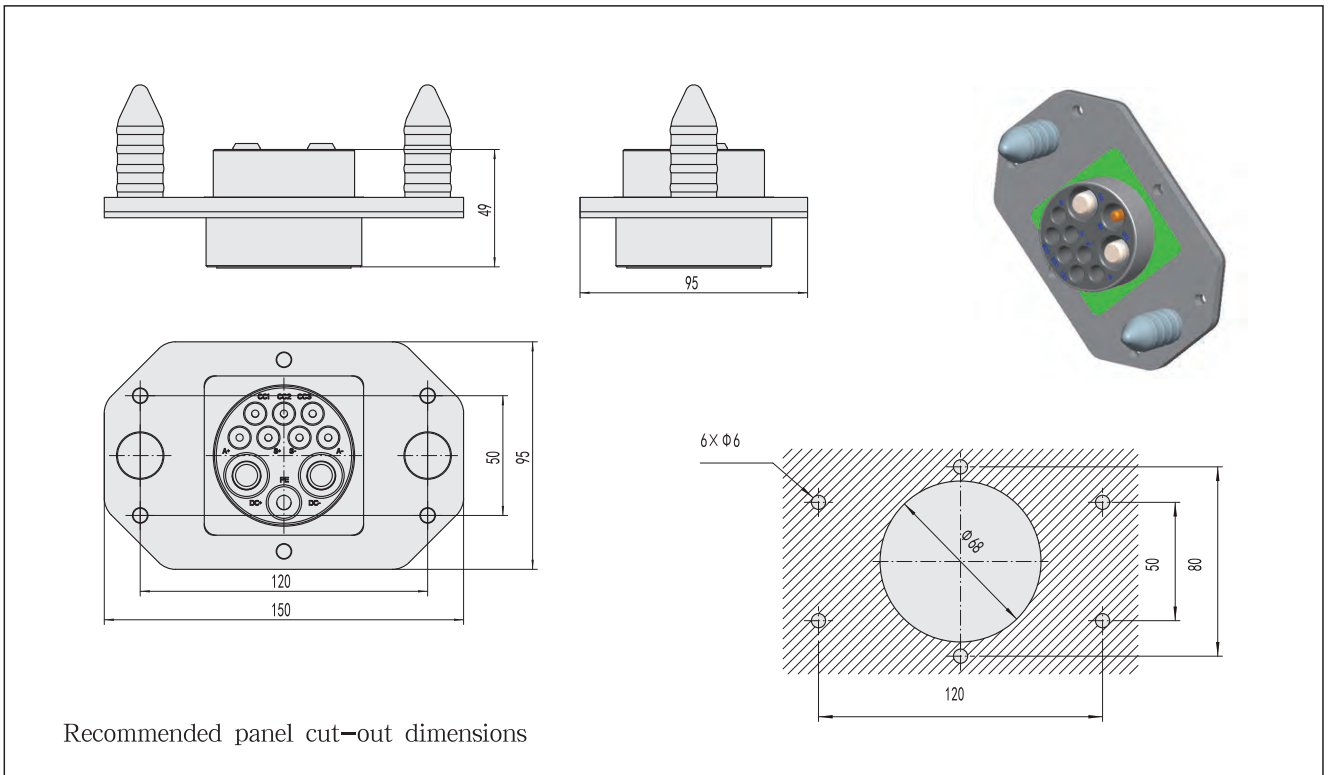

[BPC30-S-250A/750V-CR (bracket carrier receptacle)]

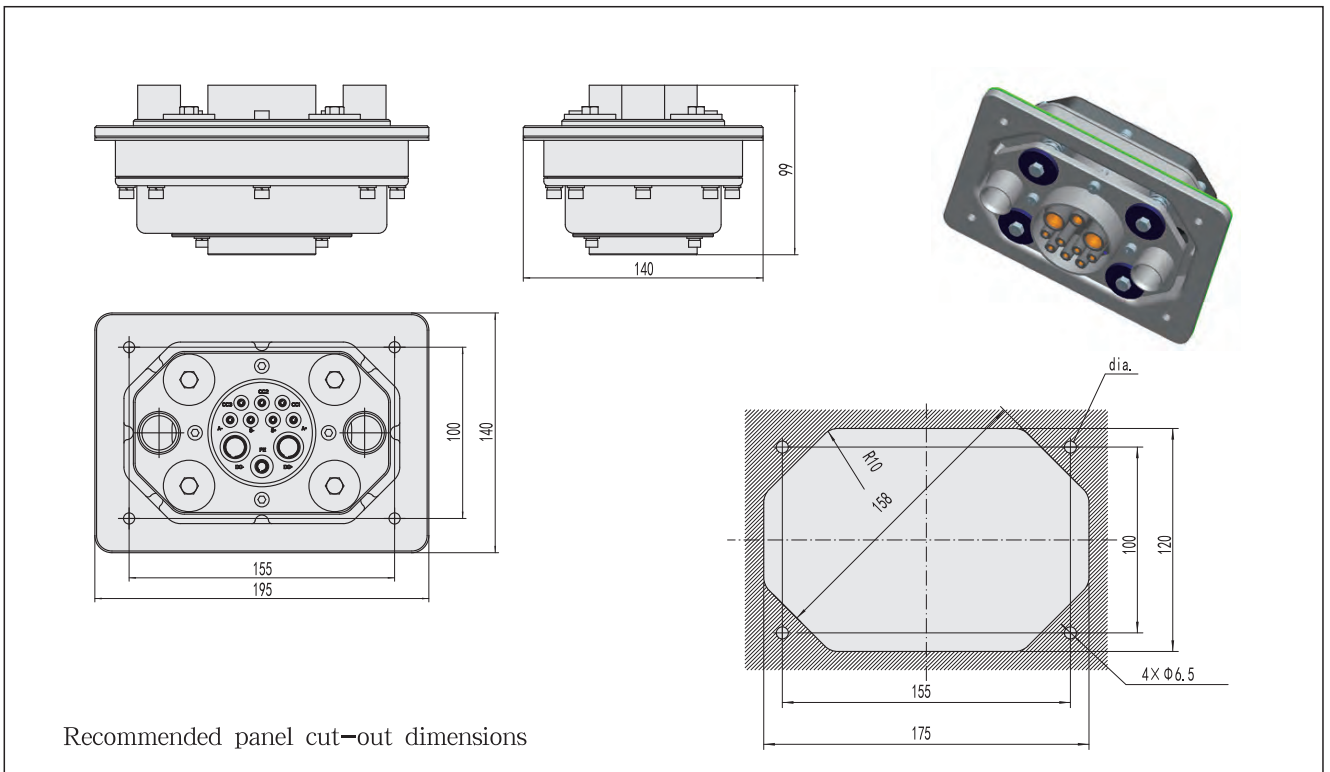

[BPC30-P-250A/750V-EV (vehicle mounting adapter)]

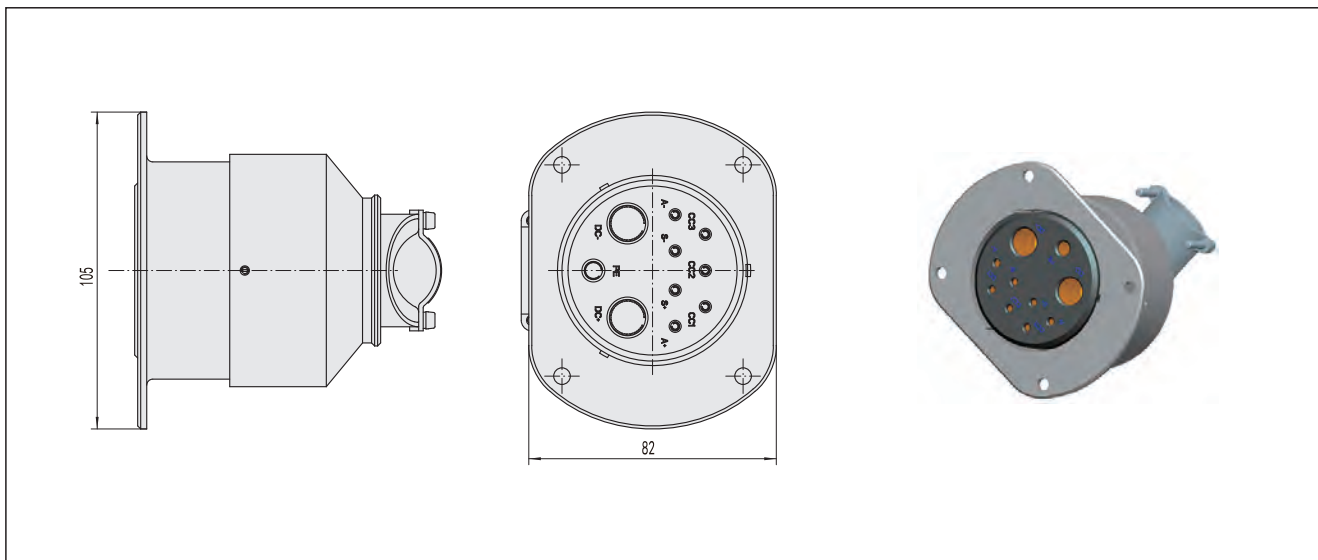

[BPC30-S-250A/750V-EV (vehicle mounting receptacle)]

